



Highfield Avenue, London, NW9 0QD

**Cow & Co**  
LONDON





Guide price £275,000 - £375,000. A lovely two bedroom top floor maisonette situated just off Roe Green offering bright and spacious accommodation throughout, contemporary style fixtures/fittings and the benefit of a large garage and off street parking.

With this property being within less than a mile of Kingsbury Town Centre with its Jubilee Line tube station on zone 4, this property could appeal to those needing to commute into Central London in around 30 minutes.



- Stunning top floor two bedroom maisonette with a fantastic front aspect views across London
- Excellent fitted handmade kitchen
- Patio doors leading to a lovely balcony
- Remodelled modern bathroom suite
- Access to loft space
- Close to local shops and amenities
- Close to all transport links
- Large Garage via own drive





# Shirley Court, Highfield Avenue, London, NW9

Approximate Area = 574 sq ft / 53 sq m

For identification only - Not to scale

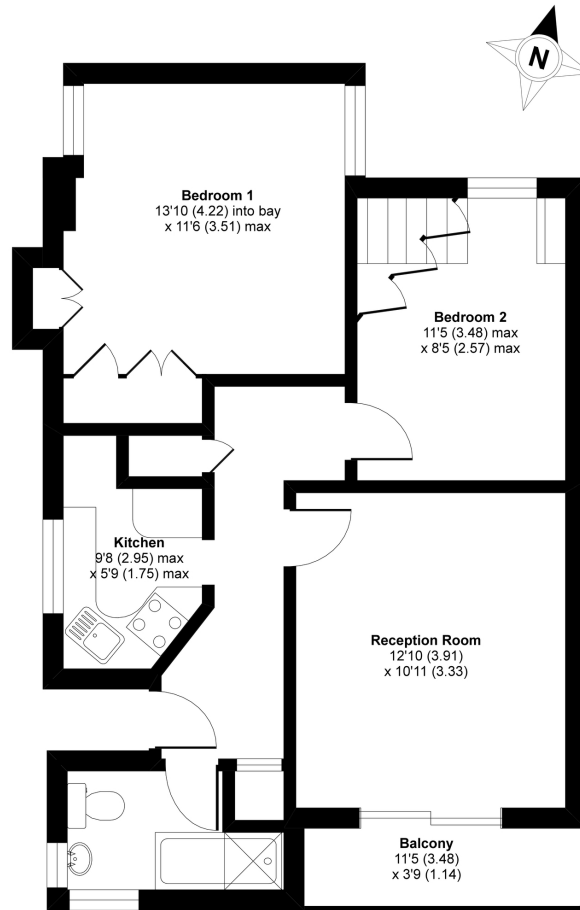

THIRD FLOOR



Floor plan produced in accordance with RICS Property Measurement Standards incorporating International Property Measurement Standards (IPMS2 Residential). © nichecom 2020. Produced for Cow & Co Properties Ltd. REF: 611053

Tel: 0208 065 0010  
Email: [thehub@cowandco-london.com](mailto:thehub@cowandco-london.com)  
Web: [cowandco-london.com](http://cowandco-london.com)

Agents note: All measurements are approximate and whilst every attempt has been made to ensure accuracy they are for general guidance only and must not be relied on. The fixture and fittings referred to have not been tested and therefore no guarantee can be given that they are in working order. Internal photographs are reproduced for general information and it must not be inferred that any item shown is included with the property.

**Cow & Co**  
LONDON