



Three Bedroom Semi-Detached House
Maunder's Close, Chatham, Kent, ME5 0AU

£355,000
Freehold

Maunder's Close, Chatham, Kent, ME5 0AU

£355,000

Freehold

Description

Being offered with no forward chain is this three bedroom extended family home. An opportunity to place your own creative stamp to make a lovely home. On entering, you are welcomed to a spacious entrance hallway which could also be utilised as a study area, downstairs cloakroom, good size lounge/ diner with feature panelling, a further reception room which is ideal as a playroom/ 4th bedroom and a kitchen/ breakfast room which is a good size offering a variety of fitted units and worksurfaces.

Moving upstairs offers three bedrooms, two of which are doubles and a good size third bedroom. The bathroom offers a three piece suite and also the benefit of a separate shower cubicle. For those looking for extra space the loft has been boarded with light and power and is great for storage but also as a hobby room.

Externally, the garden is offered with low maintenance in mind, greenhouse and summer house to remain with gated side access leading to garage and driveway and additional parking to the front. Please call the sales team for further details.

Key Features

- No forward Chain
- Three bedroom extended
- Downstairs Cloakroom
- Cul-de-sac position
- Two Reception rooms
- Loft room
- Garage and Parking
- Garden 25'5" x 16'4"

Local Area

Chatham is located within the Medway towns with good transfer links by rail into Central London and Ebbsfleet International plus road connections to the M2/M25 & M20. Amenities include a bustling Town Centre, the Historic Dockyard, Capstone Ski & Snowboard centre and nearby Gillingham FC and Rochester Castle & Cathedral.

GROUND FLOOR
746 sq.ft. (69.3 sq.m.) approx.

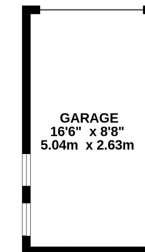
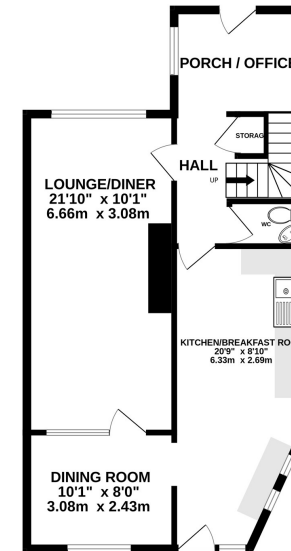

1ST FLOOR
414 sq.ft. (38.4 sq.m.) approx.

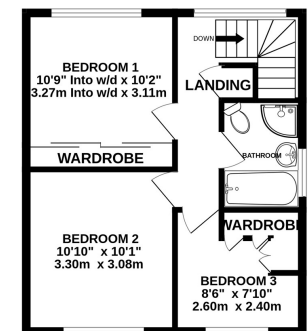

TOTAL FLOOR AREA : 1159 sq.ft. (107.7 sq.m.) approx.

Whilst every attempt has been made to ensure the accuracy of the floorplan contained here, measurements of doors, windows, rooms and any other items are approximate and no responsibility is taken for any error, omission or mis-statement. This plan is for illustrative purposes only and should be used as such by any prospective purchaser. The services, systems and appliances shown have not been tested and no guarantee as to their operability or efficiency can be given.
Made with Metropix ©2024



Property Location

Maunders Close, Chatham, Kent, ME5 0AU

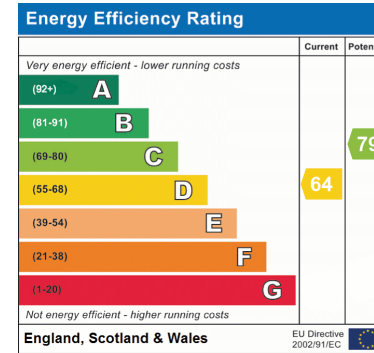
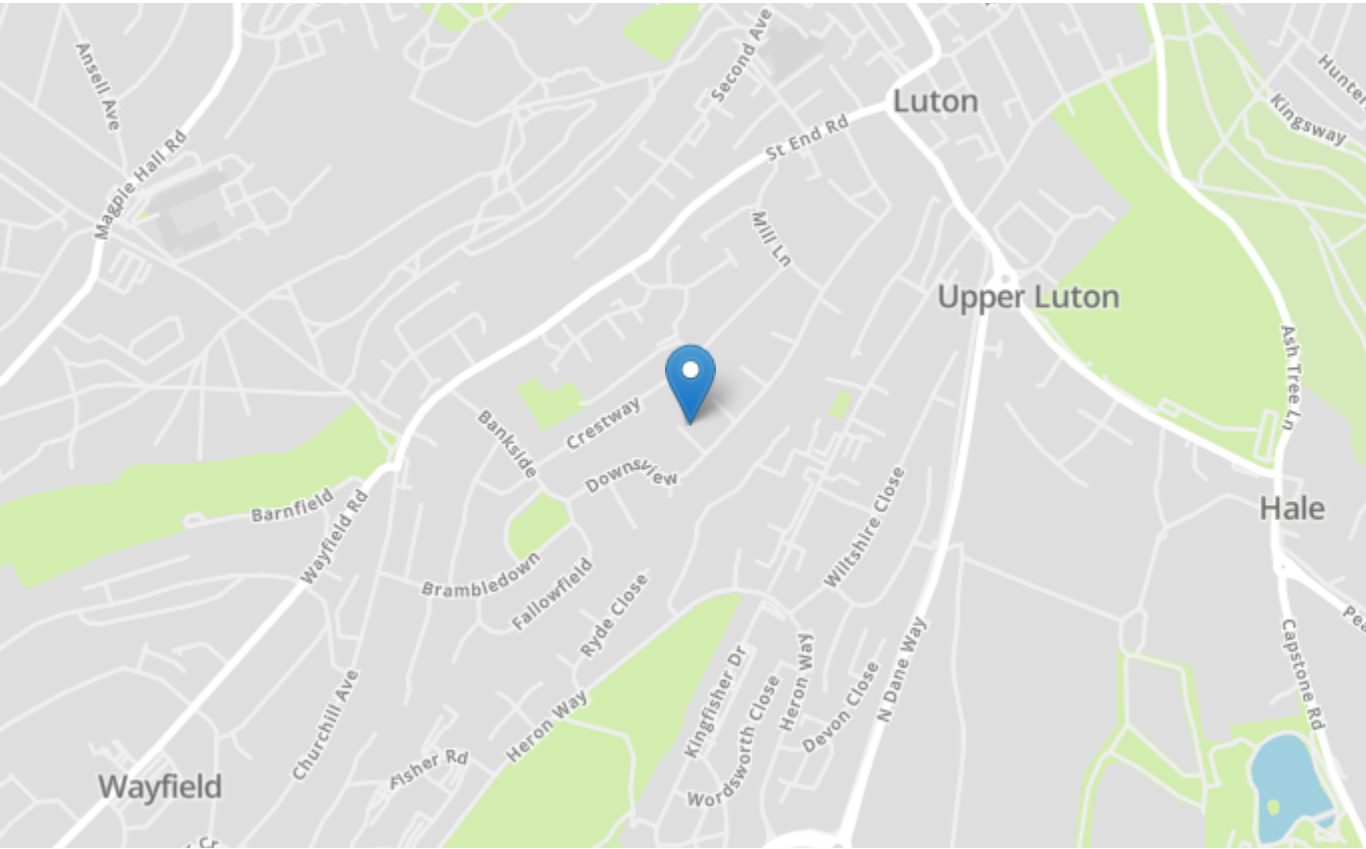

Tenure	Freehold
Lease Term	N/A
Ground Rent	N/A
Service Charge	N/A
Local Authority	Medway
Council Tax	Band C

Greyfox Walderslade

Unit 2, Thetford House
Walderslade Village Centre
Walderslade Road
Chatham
Kent
ME5 9LR
Tel: 01634 672227 Email:
walderslade@greyfox.co.uk

Greyfox Rainham

67C High Street
Rainham
Kent
ME8 7HS
Tel: 01634 377737 Email:
rainham@greyfox.co.uk

Agent Notes

These particulars are prepared as a general guide to a broad description of the property and should not be relied upon as a statement or representation of fact and do not constitute part of an offer or contract. The seller does not make or give nor do our employees or Greyfox have authority to make or give any representation or warranty to the property. We have not carried out a structural survey and the services, appliances and specific fittings have not been tested. All photographs, measurements, floorplans and distances referred to are given as a guide only and should not be relied upon for the purchase of carpets or any other fixtures or fittings. Lease details, service charges and ground rent (where applicable) and council tax are given as a guide only and should be checked and confirmed by you on inspection and your solicitor prior to exchange of contracts. If there are any points of particular importance to you we will be pleased to check the information for you and to confirm that the property remains available. This is particularly important should you be travelling some distance to view and where statements have been made by us to the effect that the information has not been verified. The copyright of all details, photographs and floorplans remain exclusive to Greyfox. For details of our privacy policy and referral fee arrangements with any of our selected partner companies please visit <https://www.greyfox.co.uk/legal/privacy> and <https://www.greyfox.co.uk/referral-fees>.