

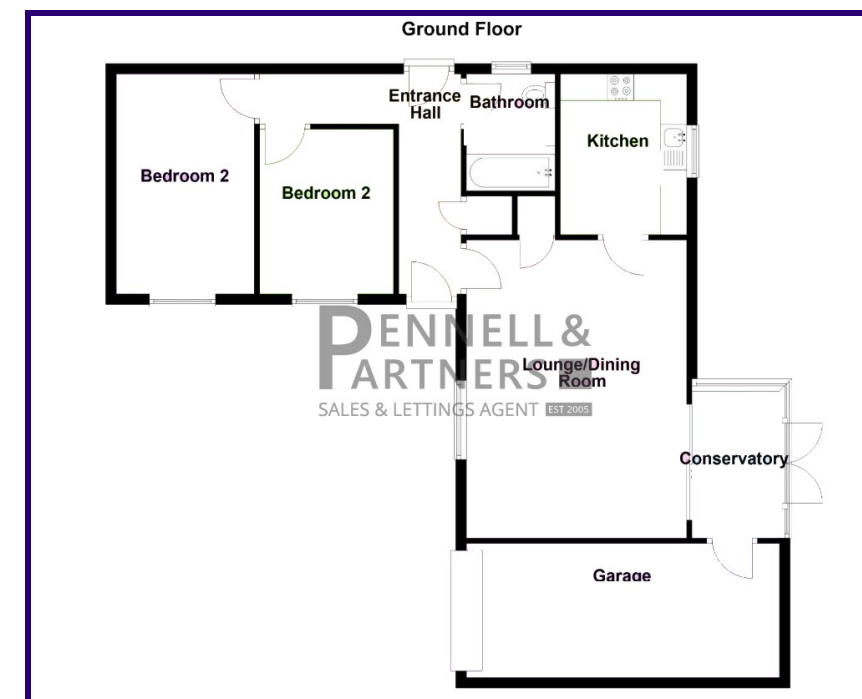

26 BARHAM CLOSE, PETERBOROUGH, CAMBRIDGESHIRE. PE2 8TU

£260,000



PENNELL & PARTNERS

Pennell & Partners, 5 Cross Street, Peterborough, PE1 1XA - 01733 209222 - hello@pennellandpartners.co.uk

ABOUT THE PROPERTY

Upon entering the property, you are welcomed by a large and bright entrance hallway which provides access to most of the rooms within the home and creates an immediate sense of space.

The lounge/diner is particularly generous in size, offering a versatile layout that easily accommodates both relaxing and dining areas, making it perfect for everyday living or entertaining guests.

The kitchen is modern and well-appointed, featuring plentiful cabinetry and ample worktop space, providing a practical and stylish environment for cooking and food preparation.

Leading from the lounge is a lean-to conservatory which enjoys pleasant views over the garden and provides direct access to the rear outdoor space, creating an ideal spot to relax and enjoy the surroundings.

Further along the hallway, the property offers two well-proportioned double bedrooms, both tastefully decorated and providing warm, comfortable living spaces.

Completing the internal accommodation is a modern and stylish bathroom finished to a high standard.

Externally, the property continues to impress with a wrap-around garden that offers a good degree of privacy thanks to established borders and planting. The garden features a combination of lawn, patio seating areas, and well-stocked planting beds, creating an attractive and versatile outdoor space to enjoy throughout the year.



EPC Rating: D (63)

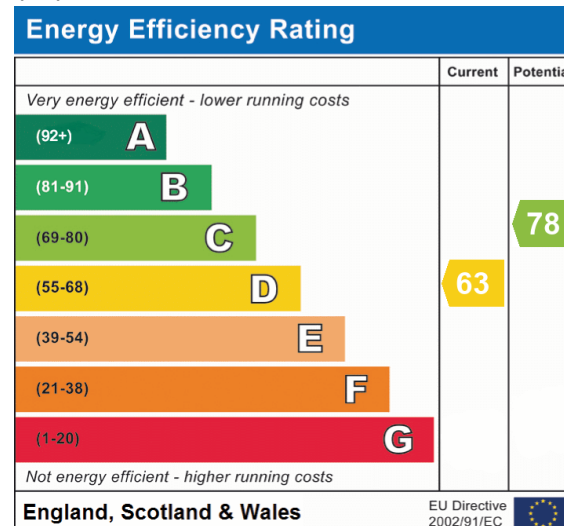

ENTRANCE HALL

LOUNGE/DINER

5.66m x 4.18m (18' 7" x 13' 9")

KITCHEN

BATHROOM

2.22m x 1.68m (7' 3" x 5' 6")

MASTER BEDROOM

4.18m x 2.62m (13' 9" x 8' 7")

BEDROOM TWO

3.13m x 2.54m (10' 3" x 8' 4")

CONSERVATORY

2.79m x 1.66m (9' 2" x 5' 5")

GARAGE

2.55m x 5.94m (8' 4" x 19' 6")

OUTSIDE

FRONT

GRAVEL DRIVEWAY
PARKING AREA IN FRONT OF GARAGE

REAR

WRAP AROUND GARDEN
LAWN
PATIO
BORDERS
ENCLOSED BY FENCING