

FOR
SALE



20 Village Way, Bartestree, Hereford HR1 4FH

£290,000 - Freehold

22, Broad Street, Hereford, HR4 9AP 01432 355455 hereford@flintandcook.co.uk

PROPERTY SUMMARY

Peacefully situated in this highly sought after village location, a modern 3 bedroom end terraced house, offering ideal first time buyer/small family accommodation. The property has the added benefit of gas central heating, double glazing, downstairs cloakroom, en-suite shower room, 2 off road parking spaces and we recommend an internal inspection. No onward chain.

POINTS OF INTEREST

- *Highly sought after village location*
- *Modern 3 bedroom end terraced house*
- *En suite shower room*
- *2 off road parking spaces*
- *Ideal for first time buyer*
- *No onward chain*
- *Must be viewed*



ROOM DESCRIPTIONS

Canopy porch

With entrance door through to the

Reception hall

with matwell, fitted carpet, radiator, stairs to the first floor and door to

Lounge

With fitted carpet, radiator, double glazed window to the front aspect, TV aerial and telephone points, central heating thermostat and door to the

Kitchen/dining room

With 1 1/2 bowl sink unit with mixer tap over, range of wall and base cupboards, work surfaces with splash backs, feature flooring, built in oven and 4 ring gas hob with splash back and cooker hood over, built in fridge freezer, space and plumbing for washing machine, double radiator, space for dining table, large understairs store cupboard, double glazed double doors to the rear patio and garden, and door to

Cloak room

with low flush WC, wash hand basin with splash back, radiator, feature flooring and extractor fan.

First Floor landing

with fitted carpet, store cupboard also housing the gas central heating boiler, access hatch to loft space and door to

Bedroom 1

With fitted carpet, radiator, double glazed window to the front aspect, recess ideal for wardrobes and door to

En suite shower room

Suite comprising corner shower cubicle with glazed folding door, low flush WC and wash hand basin, ladder-style towel rail/radiator, double glazed window, tiled display shelf and extractor fan.

Bedroom 2

With fitted carpet, radiator, space for wardrobes and double glazed window to the rear.

Bedroom 3

With fitted carpet, radiator and double glazed window to the rear.

Bathroom

With suite comprising, panel bath with tiled surround and shower unit over with glazed screen, wash hand basin with shaver socket and a display shelf over, low flush WC, ladder style towel rail/radiator and extractor fan.

Outside

To the front of the property there is a driveway providing off road parking for two vehicles. A pathway to the side provides access to the rear.

To the immediate rear of the property, there is a paved patio area providing the perfect entertaining space which leads onto the remainder of the garden which is laid to lawn, enclosed by fencing for privacy.. Useful timber garden shed, outside tap and side access gate.

Services

Mains water, electricity, drainage and gas are connected. Gas fired central heating.

Outgoings

Council tax band C, payable 2024/25 £2058.16. Water and drainage - metered supply.

Viewings

Strictly by appointment through the Agent, Flint and Cook, 01432 355455.

Directions

Proceed east out of Hereford City on the A438 Ledbury Road, on reaching Bartestree, turn right into Village Way.

Money laundering regulations

Prospective purchasers will be asked to produce identification documentation and proof of funds at the time of making an offer.

Ground Floor

Approx. 39.1 sq. metres (421.0 sq. feet)

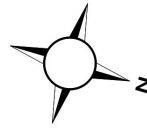
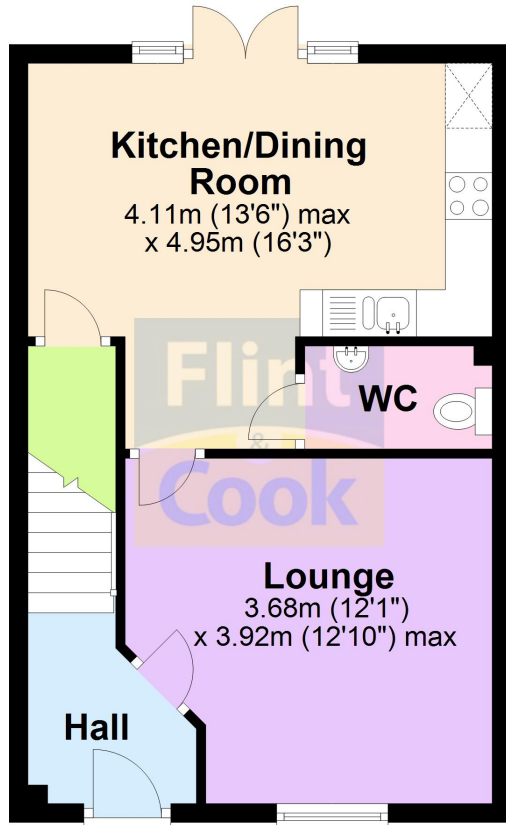

First Floor

Approx. 39.1 sq. metres (420.5 sq. feet)

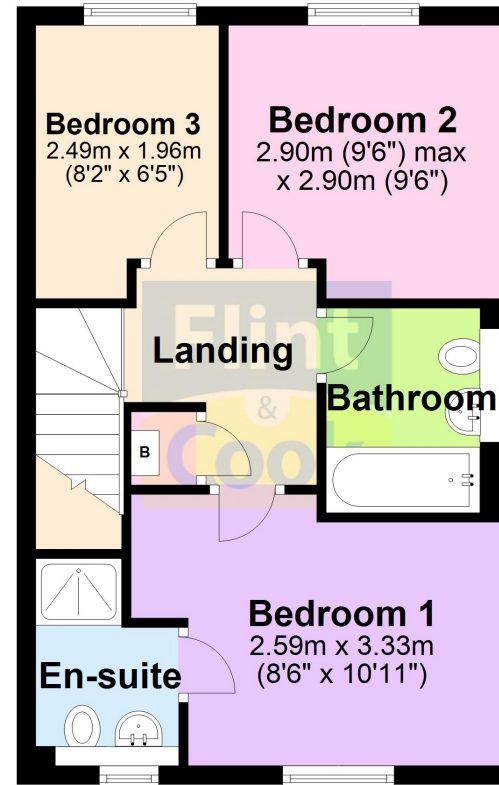

Total area: approx. 78.2 sq. metres (841.5 sq. feet)

This plan is for illustrative purposes only
Plan produced using PlanUp.

These particulars are prepared for the guidance only of prospective purchasers. They are intended to give a fair and overall description of the property and do not constitute the whole or any part of an offer or contract. Any information contained herein (whether in text, plans or photographs) is given in good faith but should not be relied upon as being a statement or representation of fact. Any plans provided by the agents and/or with the sales particulars are intended for guidance purposes only; we cannot guarantee the accuracy and scale of any plans, and they do not form any part of the sales contract. Nothing in these particulars shall be deemed to be a statement that the property is in good condition or otherwise nor that any services or facilities are in good working order. Any movable contents, fixtures and fittings, (whether wired or not) referred to in these property particulars (including any shown in the photographs) are, unless the particulars say otherwise, excluded from the sale. In the event that the buyer proposes to purchase any movable contents or include them in any offer for the property, the buyer cannot in any respect imply any such inclusion from the property particulars. Any areas, measurements or distances referred to herein are approximate only and may be subject to amendment. It should not be assumed that the property has all necessary planning, building regulation or other consents and these matters must be verified by an intending purchaser. The information in these particulars is given without responsibility on the part of the agents or their clients and neither the agents nor their employees have any authority to make or give any representations or warranties whatever in relation to this property.

Flint & Cook Privacy Statement: We take your privacy very seriously. Your data will not be shared with any other parties without your express permission. Our Data protection Policy can be read in full on the Flint & Cook website, www.flintandcook.co.uk

| Energy Efficiency Rating | | |
|---|---------|-----------|
| | Current | Potential |
| Very energy efficient - lower running costs | | |
| (92+) A | | 96 |
| (81-91) B | 84 | |
| (69-80) C | | |
| (55-68) D | | |
| (39-54) E | | |
| (21-38) F | | |
| (1-20) G | | |
| Not energy efficient - higher running costs | | |
| England, Scotland & Wales | | |
| EU Directive 2002/91/EC | | |