



Two Bedroom Terraced House

Raleigh Close, Walderslade, Chatham, Kent, ME5 7SB

£240,000

Freehold



# Raleigh Close, Walderslade, Chatham, Kent, ME5 7SB

£240,000

Freehold

## Description

No chain. Situated in a popular area with convenient access to supermarket and other local amenities, this would be an excellent purchase for the first time buyer or investor alike. The front is approached along a walkway and there is an allocated parking space to the rear of the property. Accommodation comprises: entrance hall with staircase to first floor, the kitchen is to the front aspect and has a range of cupboards and work surfaces over. The lounge is to the rear and has sliding patio doors leading out to the garden. Upstairs are two double bedrooms and a bathroom with a bath and shower over. The garden has rear gate access to the parking space.

Please contact 01634 672227 to book a viewing.

## Key Features

- Two Bedroom Terrace House
- No Chain
- Double Bedrooms
- Popular Location
- Allocated Parking Space
- Local Amenities
- Walderslade
- Rear Garden approx 25ft in length

## Local Area

Walderslade is within reach of local primary and secondary schools, shopping parades, doctors surgery and dentist. Being close to Chatham and Maidstone town centres, Capstone Valley Ski and Snowboard Centre, Historic Rochester and Dockside centre plus Bluewater Shopping Centre being approximately 20 minutes away by car. The area offers good transport links to the A2/M2, M20 and M25 plus Ebbsfleet International and Ashford.

GROUND FLOOR  
319 sq.ft. (29.7 sq.m.) approx.

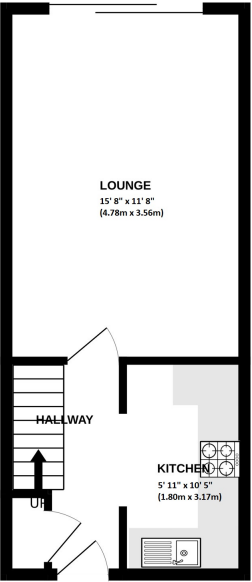

1ST FLOOR  
298 sq.ft. (27.7 sq.m.) approx.

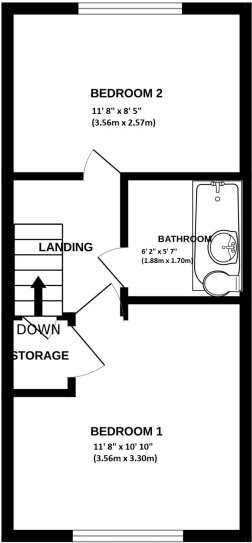

TOTAL FLOOR AREA : 617 sq.ft. (57.3 sq.m.) approx.

Whilst every attempt has been made to ensure the accuracy of the floorplan contained here, measurements of doors, windows, rooms and any other items are approximate and no responsibility is taken for any error, omission or mis-statement. This plan is for illustrative purposes only and should be used as such by any prospective purchaser. The services, systems and appliances shown have not been tested and no guarantee as to their operability or efficiency can be given.  
Made with Metropix ©2024



### Property Location

Raleigh Close, Walderslade, Chatham, Kent, ME5 7SB

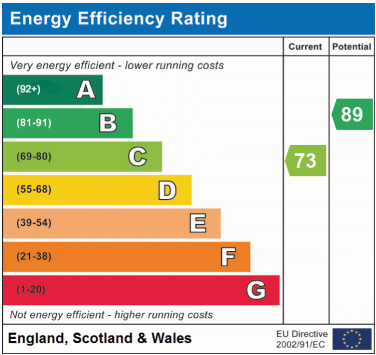
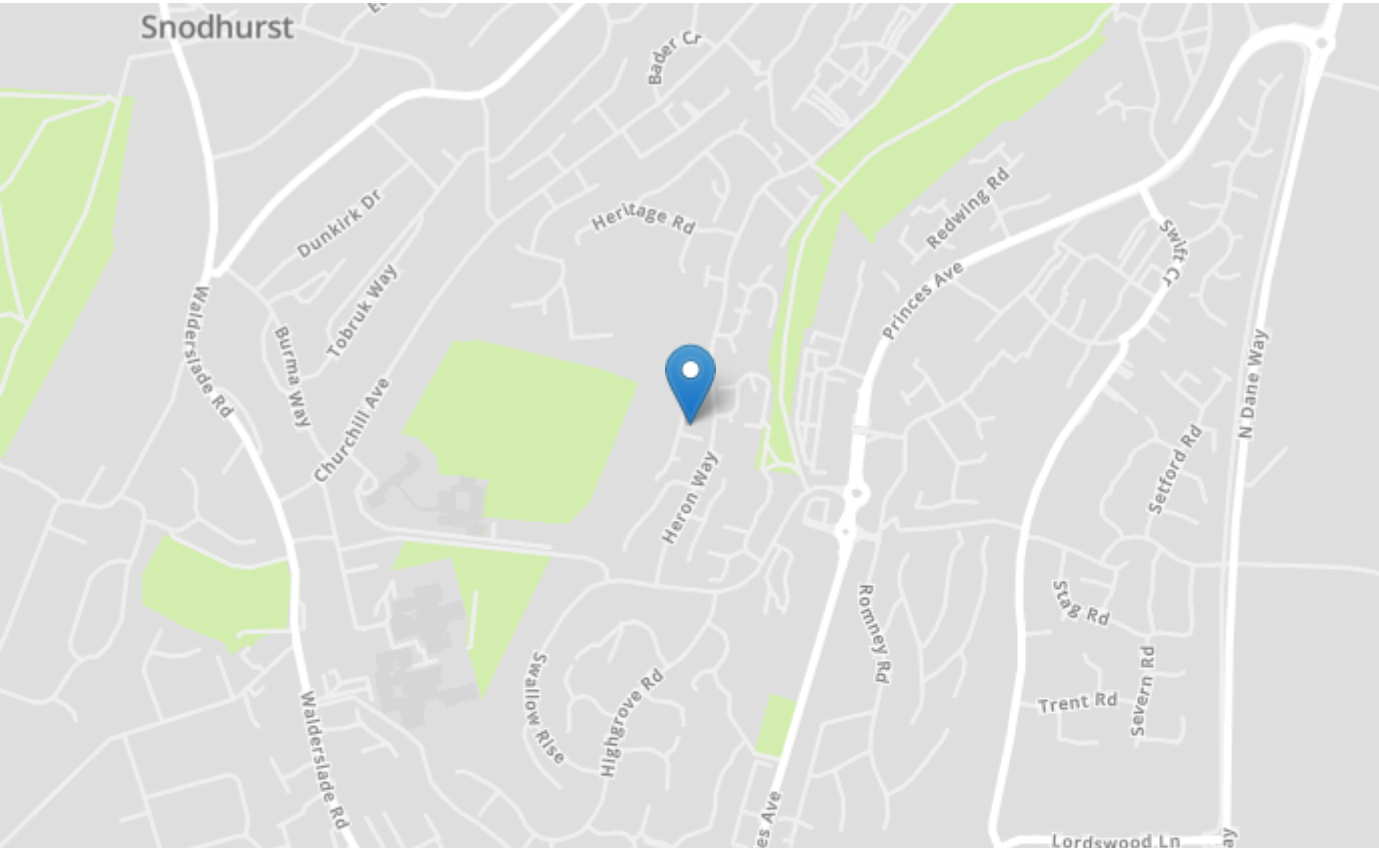

Tenure	Freehold
Lease Term	N/A
Ground Rent	N/A
Service Charge	Grounds upkeep £583.75 P/A
Local Authority	23/24 Medway
Council Tax	Band B

**Greyfox Walderslade**  
Unit 2, Thetford House  
Walderslade Village Centre  
Walderslade Road  
Chatham  
Kent  
ME5 9LR  
Tel: 01634 672227 Email: [walderslade@greyfox.co.uk](mailto:walderslade@greyfox.co.uk)

**Greyfox Rainham**  
67C High Street  
Rainham  
Kent  
ME8 7HS  
Tel: 01634 377737 Email: [rainham@greyfox.co.uk](mailto:rainham@greyfox.co.uk)

**Agent Notes**  
These particulars are prepared as a general guide to a broad description of the property and should not be relied upon as a statement or representation of fact and do not constitute part of an offer or contract. The seller does not make or give nor do our employees or Greyfox have authority to make or give any representation or warranty to the property. We have not carried out a structural survey and the services, appliances and specific fittings have not been tested. All photographs, measurements, floorplans and distances referred to are given as a guide only and should not be relied upon for the purchase of carpets or any other fixtures or fittings. Lease details, service charges and ground rent (where applicable) and council tax are given as a guide only and should be checked and confirmed by you on inspection and your solicitor prior to exchange of contracts. If there are any points of particular importance to you we will be pleased to check the information for you and to confirm that the property remains available. This is particularly important should you be travelling some distance to view and where statements have been made by us to the effect that the information has not been verified. The copyright of all details, photographs and floorplans remain exclusive to Greyfox. For details of our privacy policy and referral fee arrangements with any of our selected partner companies please visit <https://www.greyfox.co.uk/legal/privacy> and <https://www.greyfox.co.uk/referral-fees>.