

Chatham Court

Station Road, Warminster, BA12 9LS

COOPER
AND
TANNER



£85,000 Leasehold

🛏 1 🛋 1 🚿 1 EPC B

Description

A pleasing one bedroom first floor apartment located in the popular Chatham Court retirement development for the 55 and over. The flat is centrally located being close to all amenities, bus stops and station. Security access. The accommodation in brief comprises communal entrance, hall, lounge/dining room, one bedrooms, shower room, kitchen, hallway. Parking is available on a first come basis. NO CHAIN

Chatham Court, Station Road, Warminster, BA12

Approximate Area = 473 sq ft / 43.9 sq m
For identification only - Not to scale

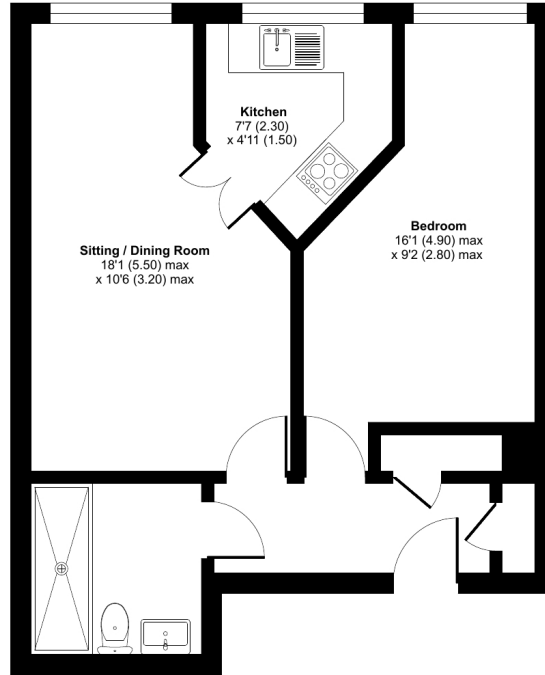

SECOND FLOOR



Floor plan produced in accordance with RICS Property Measurement Standards incorporating International Property Measurement Standards (IPMS2 Residential). © richcom 2024. Produced for Cooper and Tanner. REF: 1151183



Features

- NO CHAIN
- One bedroom
- Retirement apartment
- 55 and over
- Close to local Park and Town
- Close to bus stops and station
- Friendly community



Local Information

- Council Tax Band B
- Tenure Leasehold
- EPC Rating B

WARMINSTER OFFICE

Telephone 01985 215579

48-50, Market Place, Warminster, Wiltshire BA12 9AN

warminster@cooperandtanner.co.uk

**COOPER
AND
TANNER**

Important Notice: These particulars are set out as a general outline only for the guidance of intended purchasers and do not constitute, nor constitute part of, an offer or contract. All descriptions, dimensions, reference to condition and necessary permissions for use and occupation, warranties and other details are given without responsibility and any intending purchasers should not rely on the m as statements or rep representations of fact but must satisfy themselves by inspection or otherwise as to the correctness of each of them.

