

# 2 The Bungalows,

8a Longleat Close, Frome BA11 4AZ



£185,000 Freehold

This bright and cheerful one-bedroom mid-terrace bungalow on Longleat Close offers a bright and low-maintenance home in a peaceful Frome location.

# 2 The Bungalows, 8a Longleat Close, Frome, BA11 4AZ

 1  1  1 EPC C

## £185,000 Freehold

### DESCRIPTION

2 The Bungalows sits in a quiet and convenient location on Longleat Close, this economical one-bedroom mid-terrace bungalow offers an excellent opportunity for those seeking a comfortable and low-maintenance home. With a welcoming south-facing aspect, the property enjoys plenty of natural light throughout the day, enhancing its warm and inviting atmosphere.

To the front of the bungalow, a small tiled patio provides a pleasant spot to sit and enjoy the sunshine, setting the tone for the easy-care nature of the home. Upon entering, you step directly into the open-plan kitchen, living, and dining area. This well-proportioned space is neutrally decorated and well-maintained, creating a bright and airy environment. The kitchen is fitted with a range of base and wall units, offering ample storage and generous worktop space, ideal for cooking and entertaining. From the main living space, there is access to a well-appointed shower room, complete with modern fittings. A corridor leads towards the rear of the home, providing access to the garden.

The bungalow's double bedroom is positioned at the front of the property. Spacious and comfortable, it offers a quiet haven for relaxation, with ample space for storage solutions to suit individual needs.

This delightful home is ideal for first-time buyers, downsizers, or those looking for a lock-up-and-leave property in a sought-after area of Frome. With its well-maintained interiors, private garden, and convenient location, this bungalow is ready to move into and enjoy.

### OUTSIDE

This outdoor area is designed for minimal upkeep while still offering an attractive and usable space. It features a gravel section, perfect for outdoor seating and entertaining, alongside a low maintenance astro turf area. Fully enclosed, the garden provides privacy and security, making it a peaceful retreat. To the front of the home, there is also a parking space.

### ADDITIONAL INFORMATION

Mains gas and electric heating. All mains services are connected.

### LOCATION

Frome is a historic and architecturally impressive Town renowned for its atmospheric streets, quirky independent shops, cafés, galleries, and performing arts. Regularly featured in 'Best Place To...' lists, Frome is now famous for its monthly Independent Market, vibrant community action, and the surprise performances of international stars at the Cheese & Grain.

Babington House, the private members' club, with its swimming pools, tennis courts, gym, bars and restaurant is only a short drive away (approximately 10 minutes); and the Hauser & Wirth Gallery in Bruton and The Newt are also both within easy reach. Connections in the area are excellent with the A37 and A303 (M3) not far away, providing access to the wider motorway network. Frome, Westbury and Warminster stations all provide regular rail services to London Paddington and London Waterloo.





# Longleat Close, Frome, BA11

Approximate Area = 344 sq ft / 32 sq m

For identification only - Not to scale

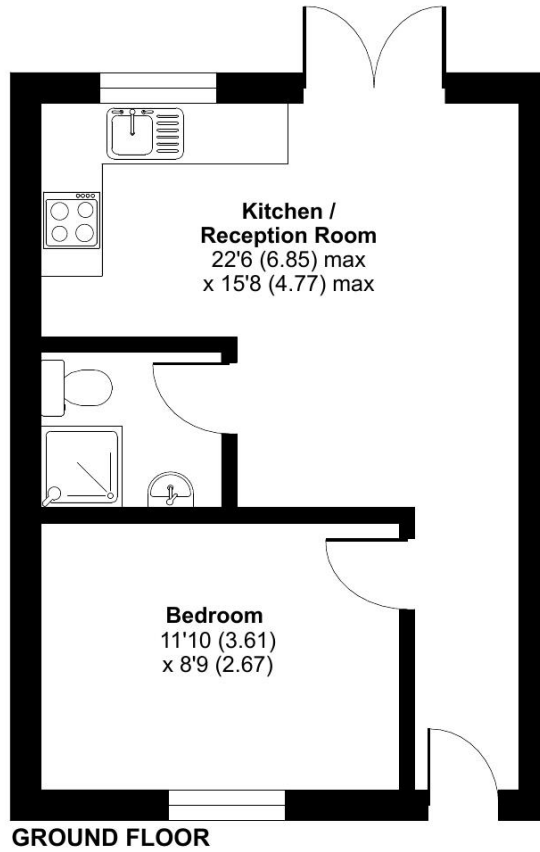

Floor plan produced in accordance with RICS Property Measurement 2nd Edition, Incorporating International Property Measurement Standards (IPMS2 Residential). © nitchecom 2025. Produced for Cooper and Tanner. REF: 1262471



## FROME OFFICE

Telephone 01373 455060

6 The Bridge, Frome, Somerset, BA11 1AR

[frome@cooperandtanner.co.uk](mailto:frome@cooperandtanner.co.uk)

**COOPER  
AND  
TANNER**

Important Notice: These particulars are set out as a general outline only for the guidance of intended purchasers and do not constitute, nor constitute part of, an offer or contract. All descriptions, dimensions, reference to condition and necessary permissions for use and occupation, warranties and other details are given without responsibility and any intending purchasers should not rely on them as statements or representations of fact but must satisfy themselves by inspection or otherwise as to the correctness of each of them.

