









Located on a sought after road in the popular St Marks area of Maidenhead is a period two bedroom cottage which comes to the market with no onward chain complications. To the ground floor is a cosy reception room with open fireplace, a dining room and kitchen overlooking the garden. There is also a useful utility space which could easily be incorporated into the main footprint. To the first floor there are two double bedrooms and a family bathroom

Externally, the long garden is bordered by mature shrubs and trees and at the bottom of the garden is an outbuilding which could be converted to a home office and a private parking space

This fantastic starter home could easily be extended STP into the loft and to the rear



-  NO CHAIN
-  POTENTIAL TO EXTEND STP
-  LONG PRIVATE GARDEN
-  OPEN FIREPLACE
-  TWO DOUBLE BEDROOMS
-  PARKING SPACE
-  CLOSE TO GOOD AND OUTSTANDING SCHOOLS

					
x2	x2	x1	x1	Y	N
Bedrooms	Reception Rooms	Bathrooms	Parking Spaces	Garden	Garage

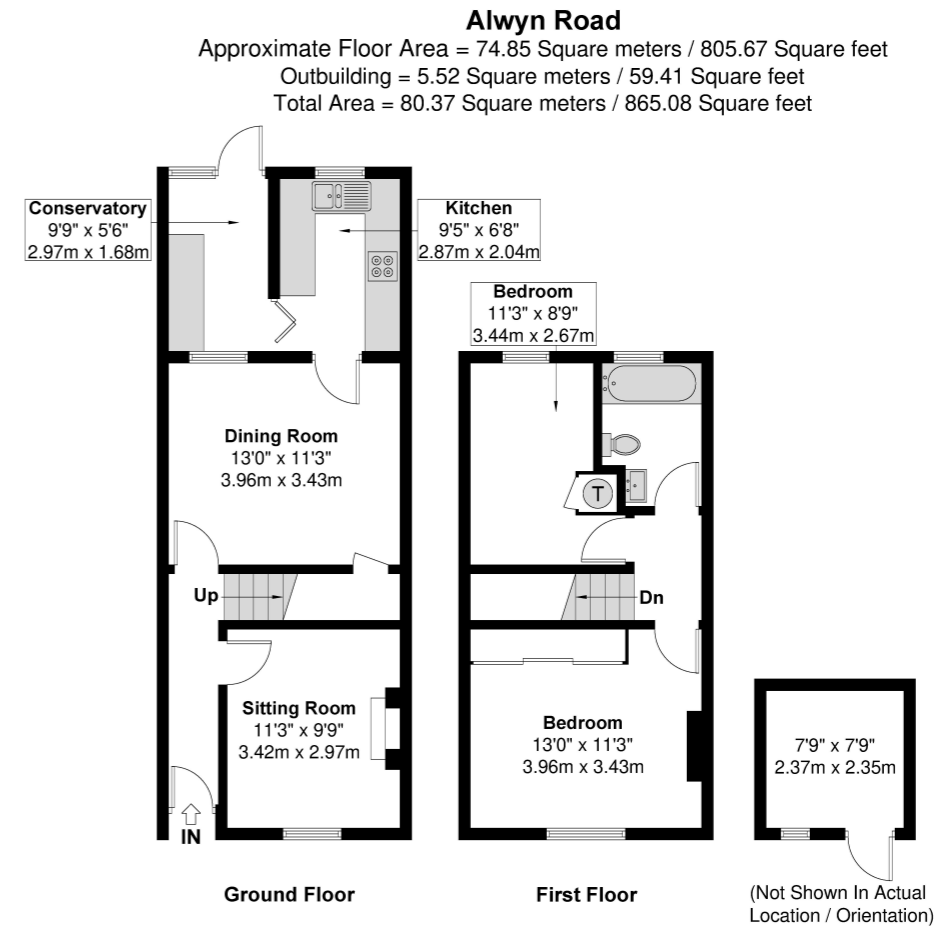

Illustration for identification purposes only, measurements are approximate, not to scale.

Prospective purchasers should be aware that these sales particulars are intended as a general guide only and room sizes should not be relied upon for carpets or furnishing. We have not carried out any form of survey nor have we tested any appliance or services, mechanical or electrical. All maps are supplied by Goview.co.uk from Ordnance Survey mapping. Care has been taken in the preparation of these sales particulars, which are thought to be materially correct, although their accuracy is not guaranteed and they do not form part of any contract.

**Location**

The property is situated in the popular St Marks area of Maidenhead, less than 5 minutes' drive from the town centre and train station and with easy access to the A404M and M4. There are a number of amenities close by such as a convenience store, a lovely community cafe and laundrette all within easy walking distance.

**Schools And Leisure**

The surrounding area provides excellent schooling for children of all ages both in the private and state sector. There are numerous sports clubs including tennis, rugby, rowing and football, various fitness centres and racing at Ascot and Windsor. The River Thames can also be accessed at Maidenhead, which is within easy reach. The local area has many walking trails, including the National Trust woodland at Maidenhead Thicket and Pinkneys Green. Nearby amenities include the newly opened Braywick Leisure Centre, a multiplex cinema, shops and restaurants.

