

FOR SALE

£435,000

Links Close, Raby Mere, Wirral. CH63 0PL



Substantial family residence! Tucked away in Links Close, the popular cul-de-sac in Raby Mere, is this extended, four double bedroom detached home. Ready for a buyer to make a house, a home - this property offers everything for a growing family. With a downstairs WC, spacious living accommodation and plenty of storage, you also find yourself with the amenities of Bromborough nearby, along with reputable primary and secondary schools and handy transport links. This opportunity is not one to be missed.





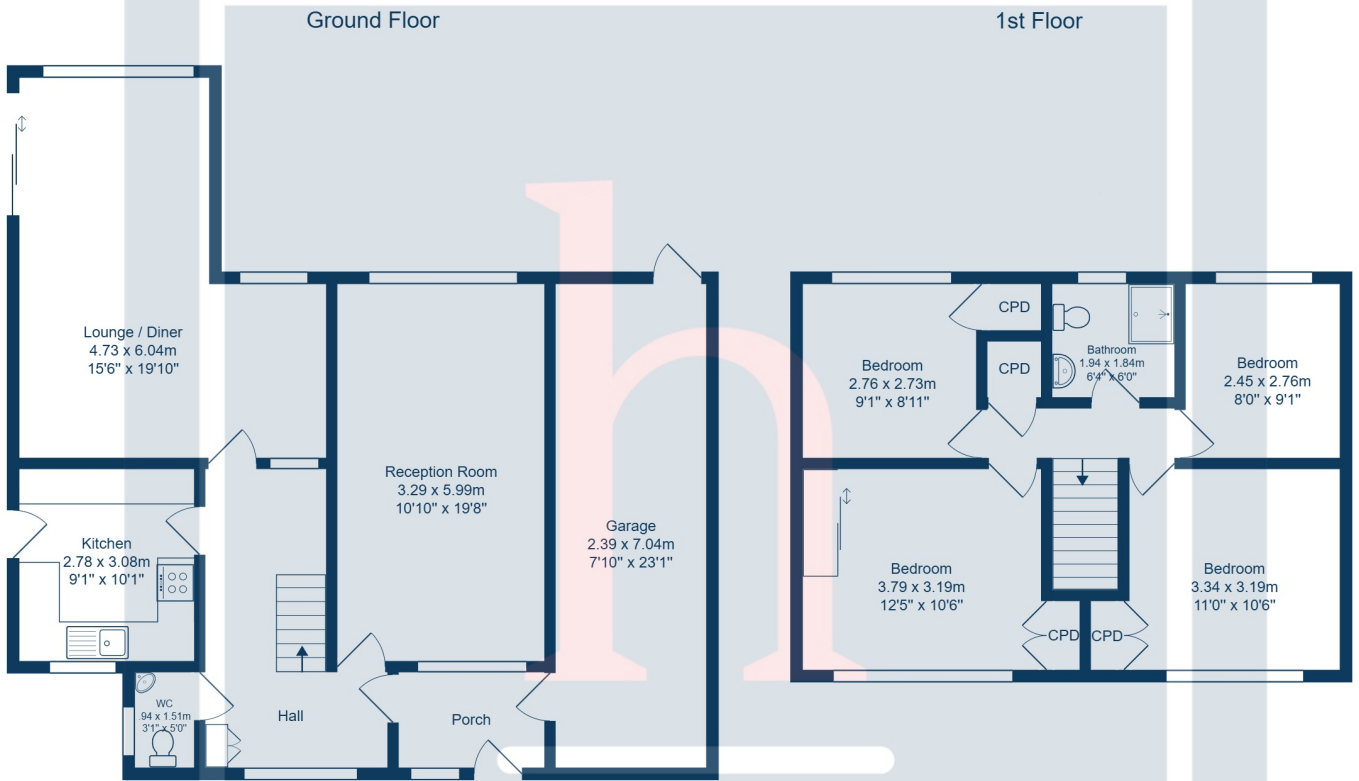

Total Area: 123.3 m² ... 1327 ft² (excluding garage)
 All measurements are approximate and for display purposes only.