



13 Common View, Letchworth Garden City, Hertfordshire. SG6 1BZ  Satchells



3 Bedroom Cottage £400,000 Freehold

A beautifully presented extended three bedroom early Garden City cottage, located in a small terrace of houses, within walking distance of the town centre.

- Family home
- south facing garden
- Early garden city cottage
- Freehold
- Extended to the rear and loft room
- Perfect for entertaining
- EPC - D - Council tax - C





These particulars are a guide only and do not constitute an offer or a contract. The floor plan is for identification purposes only and not to scale. All measurements are approximate and should not be relied upon if ordering furniture, white goods and flooring etc. We have presented the property as we feel fairly describes it but before arranging a viewing or deciding to buy, should there be anything specific you would like to know about the property please enquire. Satchells have not tested any of the appliances or carried out any form of survey and advise you to carry out your own investigations on the state, condition, structure, services, title, tenure, and council tax band of the property. Some images may have been enhanced and the contents shown may not be included in the sale. Satchells routinely refer to 3rd party services for which we receive an income from their fee. If you would like us to refer you to one of these services please ask one of our staff who will pass your details on. We advise you check the availability of the property on the day of your viewing.

Ground Floor

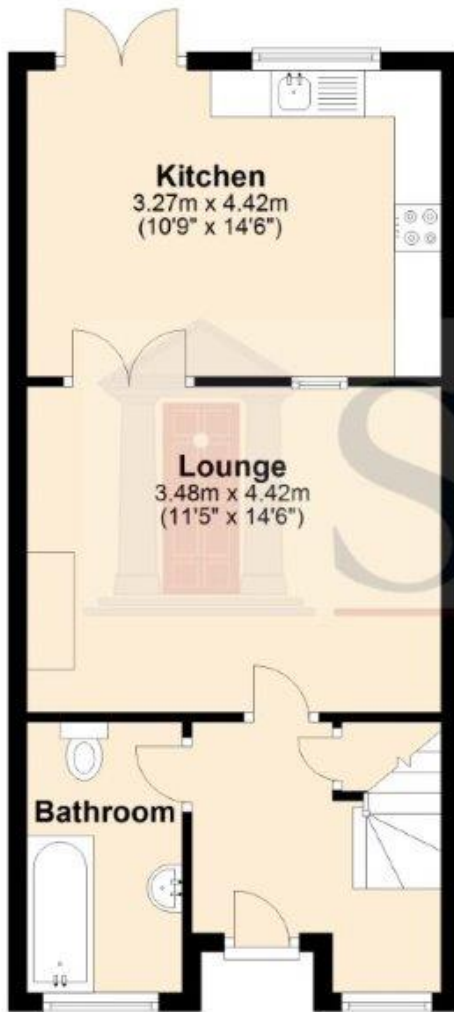

First Floor

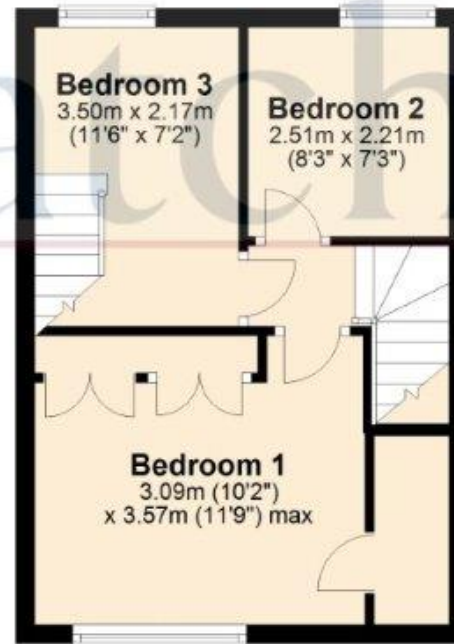

Second Floor

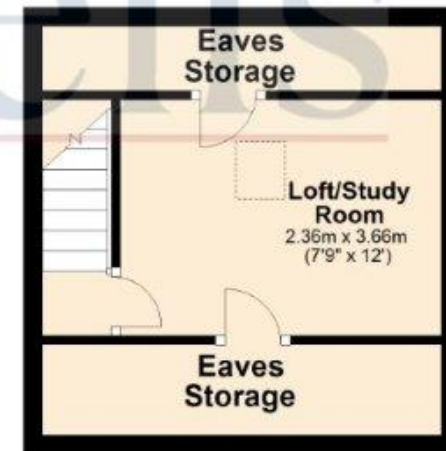

For illustrative purposes only - NOT TO SCALE - Measurements shown are approximate. The size and position of doors, windows, appliances and other features are approximate.
Plan produced using PlanUp.