

FOR SALE

Kentmere Drive, Pensby, Wirral. CH61 5XW

Offers in Excess of £255,000



Popular Family Location! This is a fantastic opportunity to purchase this well-presented three bedroom semi-detached home on the sought after Kentmere Drive in Pensby. Offering spacious living accommodation throughout, this property is situated nearby to excellent amenities and reputable local schools making it the ideal purchase for a young family.

Ground Floor

Porch

Lounge

15' 2" x 12' 0" (4.62m x 3.66m)

Kitchen/Diner

15' 4" x 9' 7" (4.67m x 2.92m)

First Floor

Bedroom

12' 0" x 9' 0" (3.66m x 2.74m)

En-Suite

3' 5" x 9' 0" (1.04m x 2.74m)

Bedroom

9' 0" x 8' 10" (2.74m x 2.69m)

Bedroom

6' 0" x 9' 10" (1.83m x 3.00m)

Bathroom

6' 1" x 5' 5" (1.85m x 1.65m)





Ground Floor

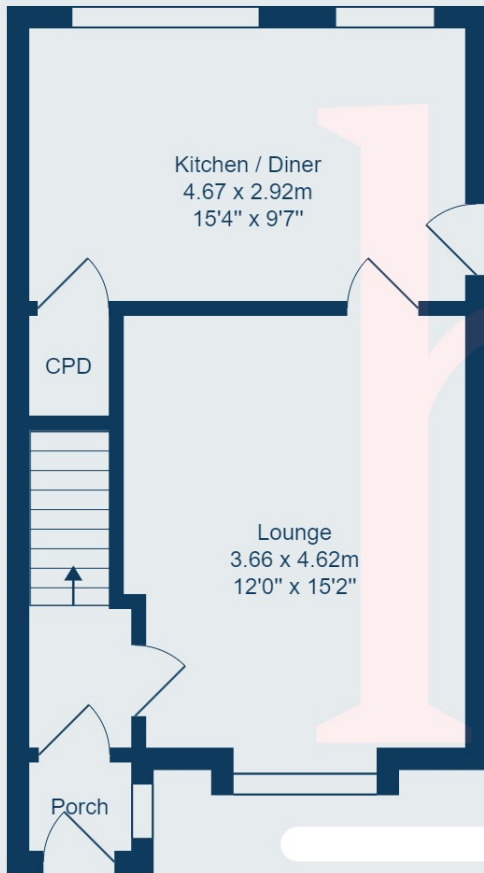

Kitchen / Diner
4.67 x 2.92m
15'4" x 9'7"

CPD

Lounge
3.66 x 4.62m
12'0" x 15'2"

Porch

1st Floor

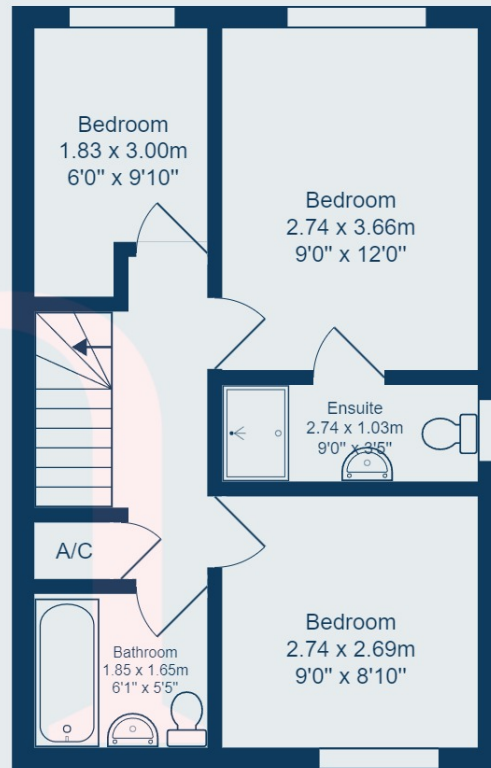

Bedroom
1.83 x 3.00m
6'0" x 9'10"

Bedroom
2.74 x 3.66m
9'0" x 12'0"

Ensuite
2.74 x 1.03m
9'0" x 3'5"

A/C

Bathroom
1.85 x 1.65m
6'1" x 5'5"

Bedroom
2.74 x 2.69m
9'0" x 8'10"

Total Area: 74.2 m² ... 798 ft²

All measurements are approximate and for display purposes only.