

Truuli



Bygrove, New Addington, Croydon, Surrey, CR0

£375,000 Freehold

- Easy access to shops, schools and transport links
- Fitted modern kitchen
- Three - well proportioned bedrooms
- Generous rear aspect reception room
- First floor bathroom
- Rear access

Lansdowne Road, Croydon, Surrey, CR9 2ER

Tel: 0330 043 0002

Email: save@truuli.co.uk Web: www.truuli.co.uk

Bygrove, New Addington, Croydon, Surrey, CR0

£375,000 Freehold

A bright and spacious three bedroom mid terrace house with a private garden, ideally situated in a popular residential area close to transport links, schools and amenities.

Recently refurbished, this perfect family home provides light, well-planned accommodation.

Ground Floor
455 sq.ft. (42.2 sq.m.) approx.

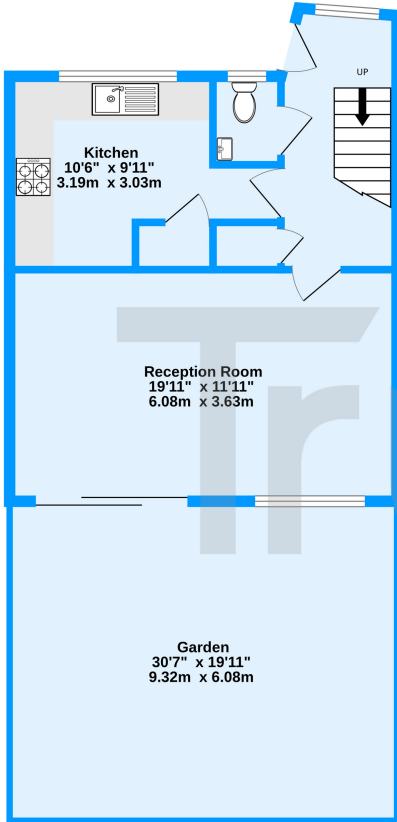

1st Floor
443 sq.ft. (41.2 sq.m.) approx.

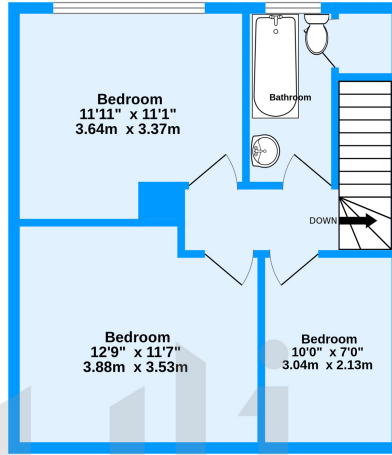

Bygrove, New Addington, Croydon, CR0
TOTAL FLOOR AREA: 898 sq.ft. (83.4 sq.m.) approx.
Measurements are approximate. Not to scale. Illustrative purposes only
Made with Metropix ©2023

Energy Efficiency Rating		Current	Potential
Very energy efficient - lower running costs			
(92-100)	A		
(81-91)	B		
(69-80)	C		76
(55-68)	D	62	
(39-54)	E		
(21-38)	F		
(1-20)	G		
Not energy efficient - higher running costs			
England, Scotland & Wales		EU Directive 2002/91/EC	

