



- Period Terraced House
- Generous Accommodation Over Three Floors
- Four Bedrooms
- Offering Tremendous Potential
- 'Bay Fronted' With Many Original Features
- Two Reception Rooms
- Minutes From Chingford Station
- TFL 5 (Liverpool St 29 Minutes)
- Highly Regarded Local Schooling
- Epping Forest

28 Buxton Road, North Chingford, London. E4 7DP.

Offering tremendous amount of potential is this well appointed and 'Bay Fronted' home set within the heart of North Chingford. Buxton Road is centrally located in North Chingford set just moments from the independent shops, bars and restaurants of Station Road. The area is hugely popular with families, the access to excellent state and private schooling is highly prized. The open spaces of Epping Forest give unparalleled access to outside spaces, Golf/Equestrian/Rugby/Tennis and more are all on the doorstep, yet access to Liverpool Street is easy, with North Chingford (TFL 5) getting you there in less than 30 minutes.



Property Details.

Ground Floor

Entrance Hall

Dining Room



15' 4" x 13' 5" (4.67m
x 4.09m)

Living Room



15' 7" x 11' 6" (4.75m
x 3.51m)

Kitchen



11' 10" x 7' 10"
(3.61m x 2.39m)

First Floor

Landing

Bedroom One



15' 5" x 10' 7" (4.70m
x 3.23m)

Property Details.

Bedroom Two



12' 7" x 10' 6" (3.84m x 3.20m)

Bedroom Four/Study



7' 8" x 7' 7" (2.34m x 2.31m)

Bathroom



WC

Second Floor

Shower Room

Bedroom Three



16' 7" x 14' 6" (5.05m x 4.42m)

Property Details.

Floorplans

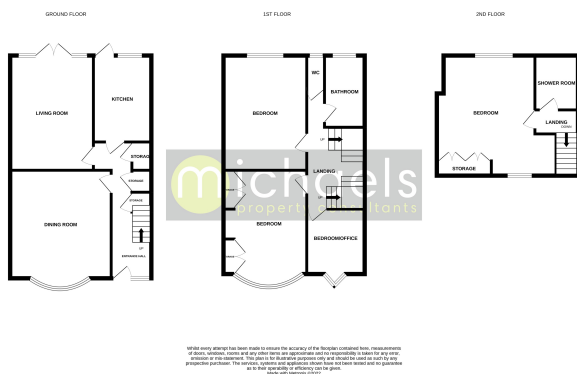

Location

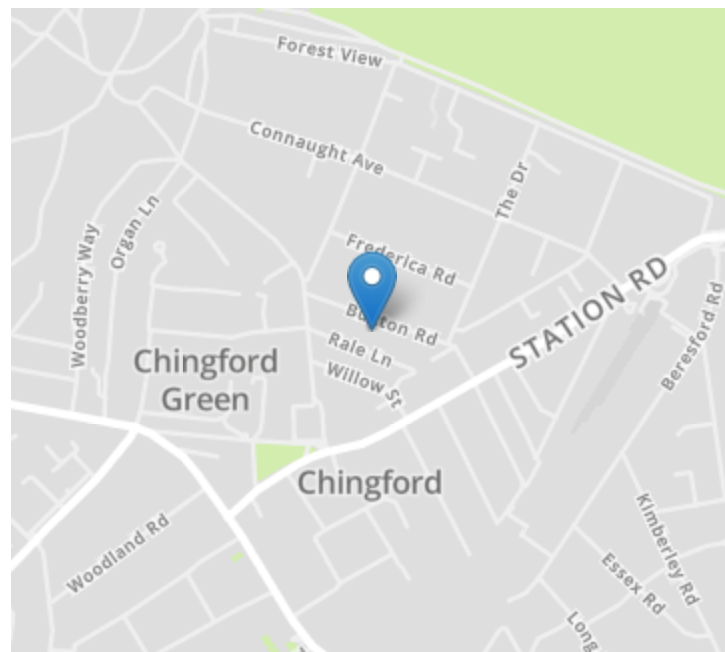

Energy Ratings

We have not carried out a structural survey and the services, appliances and specific fittings have not been tested. All photographs, measurements, floor plans and distances referred to are given as a guide only and should not be relied upon for the purchase of carpets or any other fixtures or fittings. Gardens, roof terraces, balconies and communal gardens as well as tenure and lease details cannot have their accuracy guaranteed for intending purchasers. Lease details, service ground rent (where applicable) are given as a guide only and should be checked and confirmed by your solicitor prior to exchange of contracts.