



Eastnor Road, London,

£300,000

Council Tax Band - C  
Energy Efficiency Rating -

**Christopher  
Russell**  
PROPERTY SERVICES



Beautifully presented two double bedroom second floor apartment situated in a lovely quiet close just minutes walk to New Eltham train station, restaurants and shopping facilities.

Presented in excellent decorative condition the property features a spacious open plan kitchen/lounge/diner with modern fitted kitchen, recently modernised bathroom suite, gas central heating, double glazing, storage and designated parking space.

Council Tax Band C.

Lease - 96 years

Ground Rent - £100.00 per annum

Service Charges - £147.00 per calendar month.

Council Tax Band C.

SECOND FLOOR  
744 sq.ft. (69.1 sq.m.) approx.

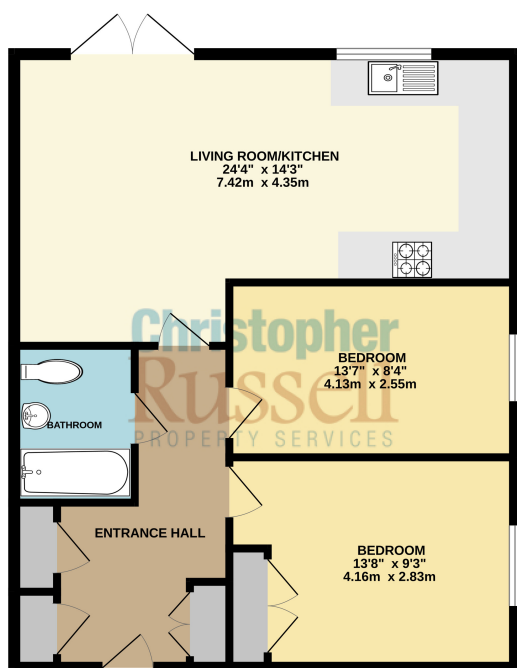

TOTAL FLOOR AREA: 744 sq.ft. (69.1 sq.m.) approx.  
While every effort has been made to ensure the accuracy of the floorplan contained herein, measurements of doors, windows, rooms and any other items are approximate and no responsibility is taken for any error or omission of measurement. This plan is for illustrative purposes only and should be used as such by any prospective purchaser. The services, systems and appliances shown have not been tested and no guarantee as to their operability or efficiency can be given.  
Made with AutoCAD 2002



Viewing by appointment only

Christopher Russell | 33, The Oval | DA15 9ER

T: 020 8300 1234 | E: sales@christopher-russell.co.uk

www.christopher-russell.co.uk

**Christopher  
Russell**  
PROPERTY SERVICES