



**Hornbeam Road  
Halewood  
Liverpool  
Merseyside  
L26 9TA**

**Offers In Excess Of £151,000**

**bettermove**

# Hornbeam Road

## Liverpool

Bettermove are pleased to present this charming three bedroom terraced house in Halewood, available with no forward chain.

The property benefits from double glazing, gas central heating throughout and has a driveway providing off street parking. The council tax band is B.

The interior of this well presented property comprises a spacious lounge, fitted kitchen/dining room and WC on the ground floor. The first floor consists of three bedrooms and the family bathroom. The exterior boasts an enclosed rear garden with lawn and patio seating areas, perfect for enjoying the summer months.

Situated in the popular town of Halewood, the property is close to a number of local amenities, including supermarkets, shops, restaurants and pubs. Excellent transport links can be found from the A562, A561, A5300, M62, M57 and Halewood rail station.

This exciting opportunity is not to be missed and all enquiries can be made through Bettermove on 0330 004 0050.

You can secure the purchase today by paying an exclusivity fee of £1,000 which gives you the rights to purchase within a given timeframe.

Paying this fee ensures that the seller takes their property off the market and reserves it exclusively for you, therefore eliminating the risk of gazumping and aborted costs.

The exclusivity fee is returned to you upon successful completion of the property.



**GROUND FLOOR**  
APPROX. 35.5 SQ. METRES (381.7 SQ. FEET)

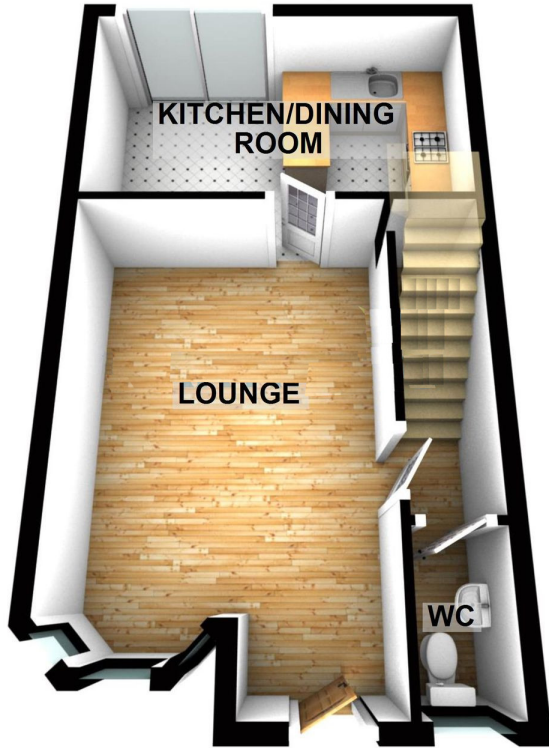

**FIRST FLOOR**  
APPROX. 36.9 SQ. METRES (396.9 SQ. FEET)

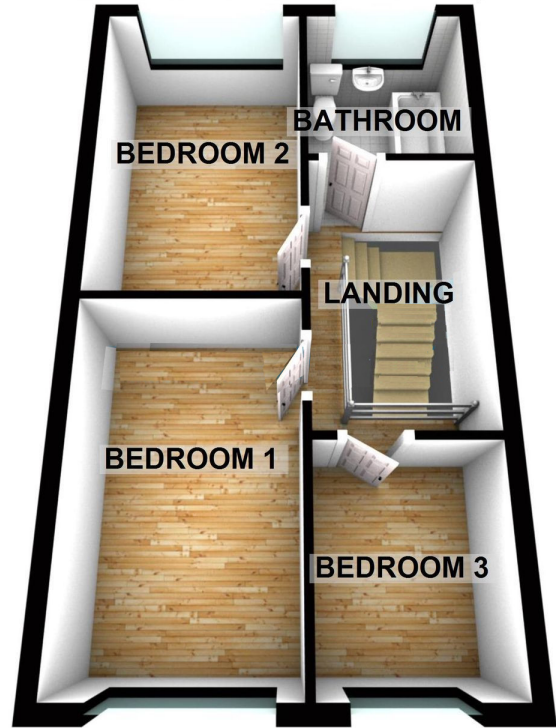

TOTAL AREA: APPROX. 72.3 SQ. METRES (778.6 SQ. FEET)

This plan is for illustrative purposes only and cannot be relied upon and no liability is taken for any errors.  
Plan produced using PlanUp.

Energy Efficiency Rating		
	Current	Potential
<i>Very energy efficient - lower running costs</i>		
(92-100) <b>A</b>		91
(81-91) <b>B</b>		
(69-80) <b>C</b>	76	
(55-68) <b>D</b>		
(39-54) <b>E</b>		
(21-38) <b>F</b>		
(1-20) <b>G</b>		
<i>Not energy efficient - higher running costs</i>		
<b>England, Scotland &amp; Wales</b>	EU Directive 2002/91/EC	

20-22 Bridge End, Leeds, LS1 4DJ  
t: 0330 004 0050 e: hello@bettermove.co.uk  
[www.bettermove.co.uk](http://www.bettermove.co.uk)