

*New*



*7 Applecross Close, Birchwood, Warrington,  
Cheshire. WA3 6UX.*

*£300,000*

Three bedroom detached bungalow | Gorse Covert | Cul de sac location | Two reception rooms |  
Driveway and double garage | Large rear garden and summer house |





GROUND FLOOR  
615 sq.ft. (57.1 sq.m.) approx.

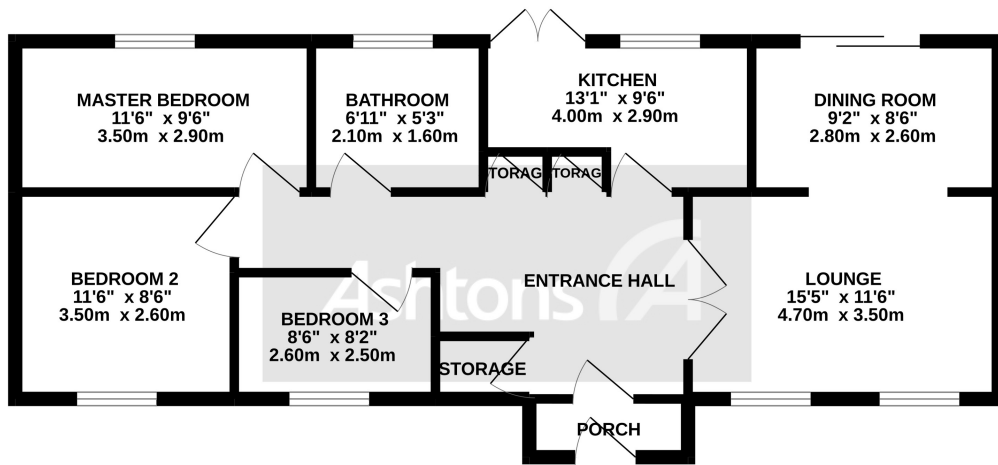

TOTAL FLOOR AREA : 615 sq.ft. (57.1 sq.m.) approx.

Whilst every attempt has been made to ensure the accuracy of the floorplan contained here, measurements of doors, windows, rooms and any other items are approximate and no responsibility is taken for any error, omission or mis-statement. This plan is for illustrative purposes only and should be used as such by any prospective purchaser. The services, systems and appliances shown have not been tested and no guarantee as to their operability or efficiency can be given.  
Made with Metropix ©2022

Located on Applecross Close, Gorse Covert is this three bedroom detached true bungalow the property is offered with no onward chain.

Upon entrance there is porch leading to the entrance hallway, lounge which opens out into the dining room with french doors to the rear garden, fitted kitchen, three bedrooms and three piece bathroom with shower over bath.

Externally there are gardens to both the front and rear and a double garage with ample parking in front of the property, the property is located on a quiet cul de sac.



*Contact your local office  
to arrange a viewing:*

**Padgate:** 01925 479334  
**Great Sankey:** 01925 454300  
**Winwick:** 01925 232146  
**Stockton Heath:** 01925 453400  
**St.Helens:** 01744 754120  
**Wigan:** 01942 498862  
**Culcheth:** 01925 764744  
**Ashton-In-Makerfield:** 01942 364446  
**Newton-Le-Willows:** 01925 907770  
**Commercial Office:** 01925 907709  
**Lettings Head Office:** 01925 873533  
**Financial Services:** 01925 221234

**Viewing Arrangements**

Viewing is strictly by appointment only through  
Ashtons Estate Agency.

**Disclaimer Property Details**

These particulars, whilst being believed to be accurate are set out as a general outline only for guidance and do not constitute any part of an offer or contract. Intending purchasers should not rely on them as statements of representation of fact, but must satisfy themselves by inspection or otherwise as to their accuracy. We have not carried out a detailed survey nor tested the services, appliances and specific furnishings. The measurements given are approximate. No person in this firm's employment has the authority to make or give any representation or warranty in respect of the property.

All details, photographs and floorplans are the copyright of Ashtons Estate Agency.

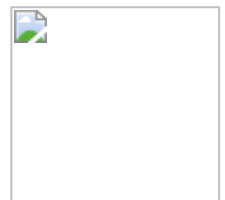

*How much you can borrow?*  
Speak to a mortgage expert in your local office.

**Ashtons Financial Services**

Ashtons.net rightmove

PrimeLocation.com Zoopla.co.uk

**Ashtons**