

# Chestnut Tree Gardens

BA12 8FD

COOPER  
AND  
TANNER



£245,000 Freehold

 2  1  1 EPC C

## Description

A lovely modern mid terraced home that is located on the Crockerton side of the town being close to woodland walks. The home has gas central heating and double glazing. The accommodation comprises an entrance hall, WC cloakroom, kitchen, lounge / dining room, landing, two bedrooms, bathroom. Outside a pathway gives access to the front door, and at the rear is a pleasing enclosed garden. Viewing advised.

## Chestnut Tree Gardens, Warminster, BA12

Approximate Area = 646 sq ft / 60 sq m

For identification only - Not to scale

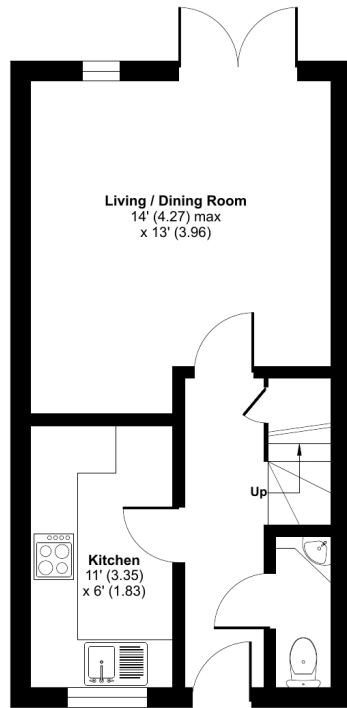

GROUND FLOOR

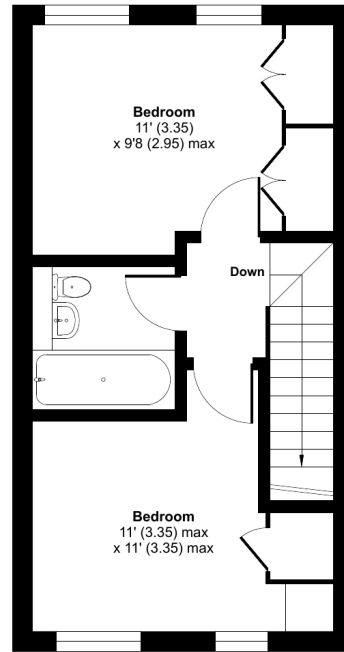

FIRST FLOOR



Floor plan produced in accordance with RICS Property Measurement Standards incorporating International Property Measurement Standards (IPMS2 Residential). © nichecom 2024. Produced for Cooper and Tanner. REF: 1126152



### Features

- Viewing advised
- Close to walks
- Popular address
- Two bedrooms
- Resident parking
- Fitted kitchen
- Lounge / dining room
- Bathroom
- Gas central heating
- Double glazing

### Local Information

- Tenure Freehold
- EPC Rating C

#### WARMINSTER OFFICE

Telephone 01985 215579

48-50, Market Place, Warminster, Wiltshire BA12 9AN

[warminster@cooperandtanner.co.uk](mailto:warminster@cooperandtanner.co.uk)

COOPER  
AND  
TANNER

Important Notice: These particulars are set out as a general outline only for the guidance of intended purchasers and do not constitute, nor constitute part of, an offer or contract. All descriptions, dimensions, reference to condition and necessary permissions for use and occupation, warranties and other details are given without responsibility and any intending purchasers should not rely on the m as statements or representations of fact but must satisfy themselves by inspection or otherwise as to the correctness of each of them.

