

# Birdwell Drive, Great Sankey, WA5 £265,000

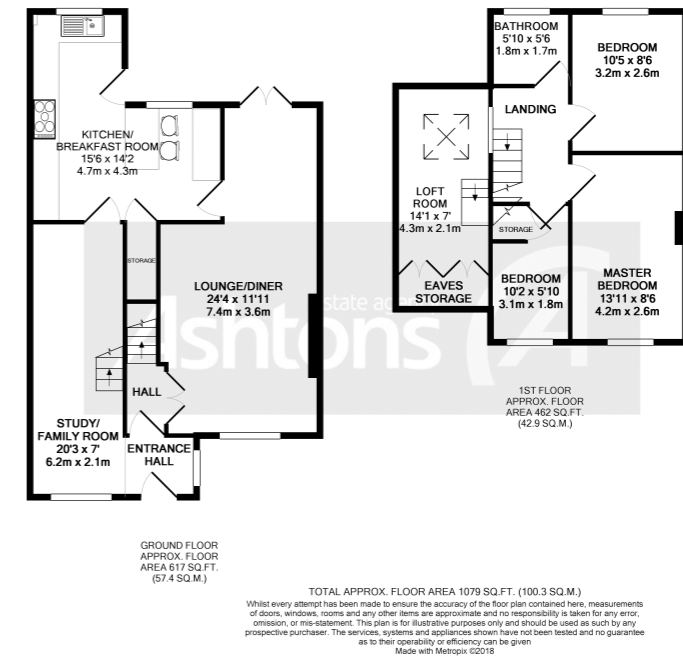

Introducing a truly captivating gem nestled in the sought-after neighborhood of Great Sankey, we proudly present this stunning 1970s semi-detached property that exudes timeless charm and modern elegance. Prepare to be enchanted by its exquisite features and stylish interior! One of the standout features of this property is the converted garage, a true testament to the versatility of this home. With a cleverly added mezzanine floor, the garage has been transformed into a multifunctional space, offering endless possibilities.

 x 3     x 1

See more of this house at [ashtons.net](https://www.ashtons.net)

