

Nansen Close, Old Hall, WA5 £200,000 OIEO



We are delighted to have on our books this very deceptive three-bedroom townhouse-style property. We encourage you to contact us at your earliest opportunity for more information, an early viewing is advised as we do not envisage it to be available for long. To view please call 01925 454300.

 x 3  x 1

[See more of this house at ashtons.net](https://www.ashtons.net)



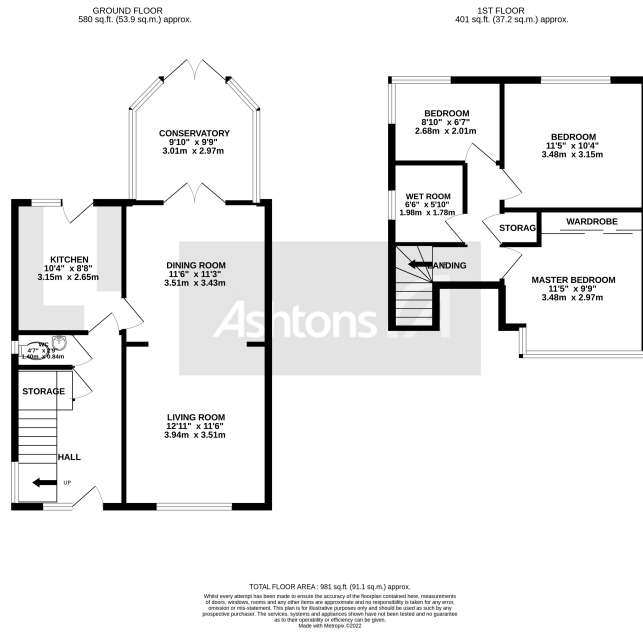

We are delighted to have on our books this very deceptive three-bedroom townhouse-style property. We encourage you to contact us at your earliest opportunity for more information, an early viewing is advised as we do not envisage it to be available for long. The accommodation is very well proportioned over both stories, and in brief, it comprises; a bright and airy entrance hall with stair access and WC., a very handy storage cupboard, a generously sized lounge with a separate dining room with conservatory with views of the garden via the patio doors and a good sized modern kitchen. Upstairs there are three well-sized bedrooms (see floor plans for dimensions), a landing, further storage space, and a wet room with a walk-in shower. There is a well-kept garden to the rear of the property with a large patio & lawn, there is also side access and rare off-road parking for multiple vehicles. To view please call 01925 454300.



www.ashtons.net



Fixtures and fittings: A list of the fitted carpets, curtains, light fittings and other items fixed to the property which are included in the sale (or may be available by separate negotiation) will be provided by the Seller's Solicitors. **Important Notice:** 1. Particulars: These particulars are not an offer or contract, nor part of one. You should not rely on statements by Ashtons in the particulars or by word of mouth or in writing ("information") as being factually accurate about the property, its condition or its value. Neither Ashtons nor any joint agent has any authority to make any representations about the property, and accordingly any information given is entirely without responsibility on the part of the agents, seller(s) or lessor(s). 2. Photos, Videos etc: The photographs, property videos and virtual viewings etc. show only certain parts of the property as they appeared at the time they were taken. Areas, measurements and distances given are approximate only. 3. Regulations etc: Any reference to alterations to, or use of, any part of the property does not mean that any necessary planning, building regulations or other consent has been obtained. A buyer or lessee must find out by inspection or in other ways that these matters have been properly dealt with and that all information is correct. 4. To find out how we process Personal Data, please refer to our Group Privacy Statement and other notices at <https://www.ashtons.net/privacy-policy/>