

GRD FLR
APPROX. FLOOR
AREA 49 SQ.FT.
(4.5 SQ.M.)

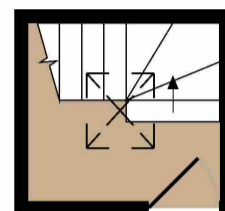

1ST FLOOR
APPROX. FLOOR
AREA 380 SQ.FT.
(35.3 SQ.M.)
TOTAL APPROX. FLOOR AREA 429 SQ.FT. (39.8 SQ.M.)



Lowther Street, YORK YO31 7LZ

Offered for sale with the benefit of no onward chain is this one double bedroom first floor flat situated within easy reach of York City Centre, hospital, train station and St Johns University. With its own private entrance and stairs leading up, this quirky property has a modern open plan living/dining/kitchen area with solid wood flooring, large double bedroom and a shower room. Externally the property has a shared courtyard and permit parking. This reasonably priced property is likely to appeal to a wide range of buyers including first time buyers and investors so early viewing is highly recommended.

Lease: 125 years from 01/2011

£300 Per Annum management charge which includes buildings insurance. Once purchased the freehold is shared with the owner of the ground floor flat.

Disclaimer - Fixtures and fittings other than those mentioned are to be agreed with the Seller. All measurements are approximate and are taken using a laser measure. Statements contained within these particulars are provided in good faith and are understood to be accurate, although cannot be guaranteed since we rely on information provided by other parties. Prospective purchasers are advised to satisfy themselves as to the validity of the information contained, either by inspection or through their solicitors, prior to making any decisions on this property. Services have not been tested and it is recommended that purchasers undertake independent tests on all services and mechanical installations, prior to exchange of contracts. Details correct at time of publication.

- No Onward Chain
- First Floor Flat
- Private Entrance
- One Double Bedroom
- Shower Room
- Walking Distance to City Centre and Hospital
- Permit Parking
- Modern Open Plan Living

Travelling along Haxby Road towards the City Centre, turn left just after the lights on to Lowther Street where the property can be found immediately on the right hand side and can be identified by our for sale sign.

The Groves, an ideal location for the Centre of York, Hospital and York St John University. Local facilities can be found in the immediate area with further facilities in York. There is a good local bus route near the property.

