



Letter Box Row

Gosmore, Hitchin,
Hertfordshire, SG4 7QE
£1,650 pcm

COUNTRY PROPERTIES
PART OF HUNTERS

Letter Box Row is positioned in the heart of the highly regarded village of Gosmore and is surrounded by mature and established greenery, a modern high quality finish whilst retaining those charming original features, stunning country style kitchen with integrated appliances which include oven with electric hob and extractor over, dishwasher, washer/dryer and fridge/freezers, master bedroom with vaulted ceilings and Juliet balcony, second double bedroom with exposed original brick work, bathroom with shower and vanity wash hand basin, easy to maintain rear garden. EPC Rating D (62)





Approximate Area = 670 sq ft / 62.2 sq m

For identification only - Not to scale

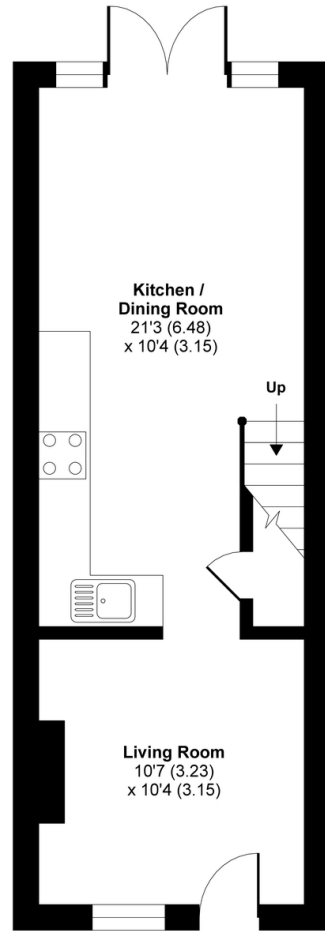

GROUND FLOOR

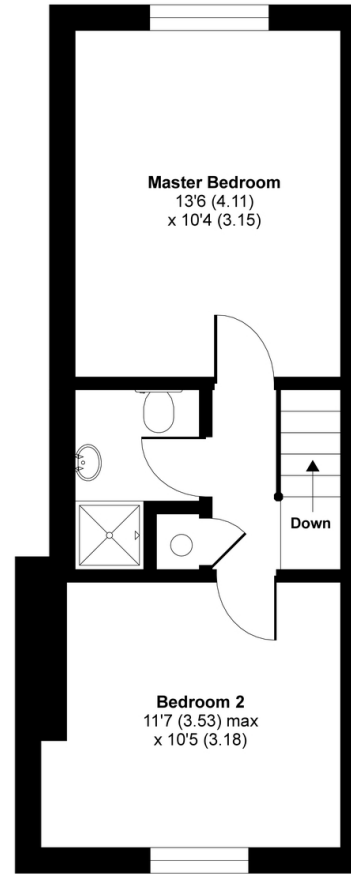

FIRST FLOOR



Floor plan produced in accordance with RICS Property Measurement Standards incorporating International Property Measurement Standards (IPMS2 Residential). © nichecom 2021. Produced for Country Properties. REF: 715397



All measurements are approximate and quoted in metric with imperial equivalents and for general guidance only and whilst every attempt has been made to ensure accuracy, they must not be relied on. The fixtures, fittings and appliances referred to have not been tested and therefore no guarantee can be given and that they are in working order. Internal photographs are reproduced for general information and it must not be inferred that any item shown is included with the property. For a free valuation, contact the numbers listed on the brochure.

Viewing by appointment only

Country Properties | 6, Brand Street | SG5 1HX

T: 01462 452951 | E: hitchin@country-properties.co.uk

www.country-properties.co.uk

